

HÄFELE



SLIDER SC SOFT CLOSE SLIDING SYSTEM

Brought to you by Häfele

SLIDER SC

FURNITURE FITTINGS FOR SUPPORTED SLIDING DOORS

The Slider SC sliding system makes installation of just about any size possible. Whether it's a new build or retrofit, the design has been carefully studied to provide easy installation and adaptation without any special fitting.

The floor running system features soft closing mechanisms integrated into the top track, with a maximum weight capacity of 50 kg per door. Silent and efficient rollers provide an effortless sliding motion.

VERTICAL PROFILES

The various vertical door profiles which are available in Silver and Black anodised provide a contemporary finish to any wardrobe.

DECORATIVE PROFILES

Optional accessories such as the decorative mid rail profile make unique design options possible.





SLIDER SC SLIDING SYSTEM

UP TO DOOR WEIGHTS OF 50 KG

EASY TO RETROFIT

SUITABLE FOR DIFFERENT
CABINET WIDTHS

The Slider SC sliding system can be supplied packaged into 2 or 3 door openings door sets or as loose components, Häfele can provide simple and economical ordering options.

All door sets are packed with vertical elements to 2750 mm. All horizontal rails supplied to opening widths as stated.

> Door height (mm):	≤2750
> Door width (mm):	900 - 1350
> Door thickness (mm):	16 - 18
> Weight capacity (kg):	<50
> Running gear:	Bottom running, 2 rollers
> Running gear guided by:	Ball bearing mounted: Plastic
> Adjustment facility (mm):	±7 on running gear
> Version:	With integrated soft close

SLIMLINE DOOR SETS

	Finish/colour	Length (mm)	Cat. No.
For 2 doors	Silver anodised	1800	944.02.020
		2700	944.02.021
	Black anodised	1800	944.02.030
		2700	944.02.031
For 3 doors	Silver anodised	2700	944.02.022
		3600	944.02.023
	Black anodised	2700	944.02.032
		3600	944.02.033

Packing: 1 set



Supplied with:

- > 1 Double guide rail
- > 1 Double bottom running rail with lip
- > 1 Horizontal door profile per door
- > 2 Slimline profiles per door
- > Fitting set



Note:

Use 6mm thick spacer under rollers and guide when using slimline profile

HANDLE DOOR SETS

	Finish/colour	Length (mm)	Cat. No.
For 2 doors	Silver anodised	1800	944.02.001
		2700	944.02.002
	Black anodised	1800	944.02.010
		2700	944.02.011
For 3 doors	Silver anodised	2700	944.02.003
		3600	944.02.004
	Black anodised	2700	944.02.012
		3600	944.02.013

Packing: 1 set



Supplied with:

- > 1 Double guide rail
- > 1 Double bottom running rail with lip
- > 1 Horizontal door profile per door
- > 2 Handle profiles per door
- > Fitting set

INDIVIDUAL COMPONENTS

DOUBLE GUIDE TRACK

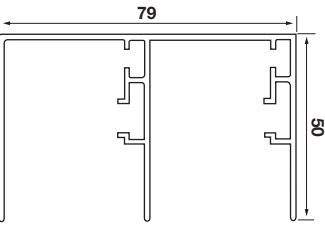

- > Top guide track, for screw fixing
- > Aluminium

Length (mm)	Silver	Black
1800	403.90.801	403.90.805
2700	403.90.802	403.90.806
3600	403.90.803	403.90.807

Packing 1 piece

DOUBLE RUNNING RAIL WITH LIP

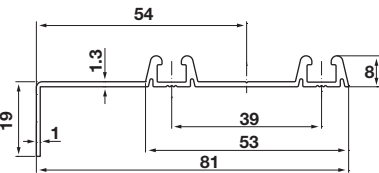

- > Bottom running rail, for screw fixing, with lip return
- > Aluminium

Length (mm)	Silver	Black
1800	403.90.602	403.90.610
2700	403.90.603	403.90.611
3600	403.90.604	403.90.612

Packing 1 piece

DOUBLE RUNNING RAIL

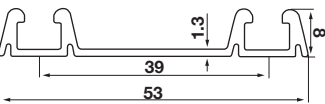

- > Bottom running rail, for screw fixing
- > Aluminium

Length (mm)	Silver	Black
1800	403.90.614	403.90.606
2700	403.90.615	403.90.607
3600	403.90.616	403.90.608

Packing 1 piece

HANDLE PROFILE

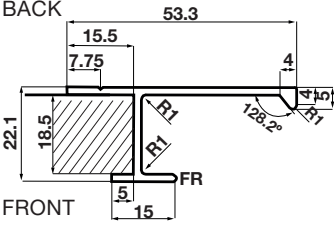

- > Handle profile, suits board thickness up to 18mm
- > Aluminium

Length (mm)	Silver	Black
2750	126.35.913	126.35.914

Packing 1 piece

WEDGE PROFILE

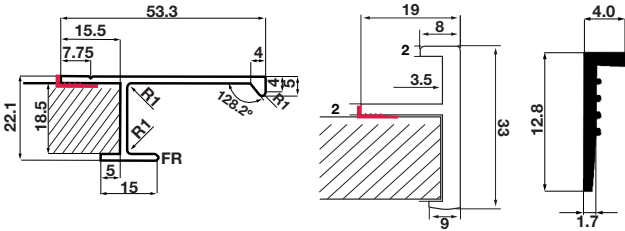

- > Wedge profile, for use when using 16mm board
- > Plastic, Black

Length (mm)	Cat. No.
3700	403.90.806

Packing 1 piece

HANDLE PROFILE

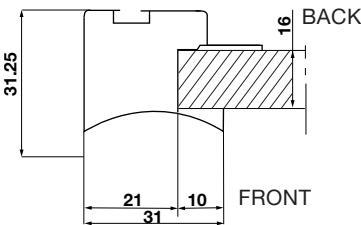

- > Handle profile, suits board thickness up to 16mm
- > Aluminium, Silver anodised

Length (mm)	Cat. No.
2900	403.93.953

Packing 1 piece

INDIVIDUAL COMPONENTS

SLIMLINE VERTICAL DOOR STILE

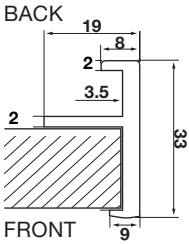

- > Slimline vertical door stile, suits board thickness up to 18mm, for frameless appearance
- > Aluminium

Length (mm)	Silver	Black
2750	944.02.328	126.14.936

Packing 1 piece

SLIMLINE HORIZONTAL DOOR STILE

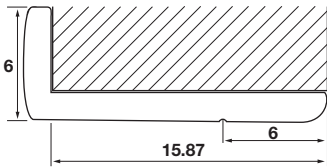

- > Slimline horizontal door stile, suits board thickness up to 18mm
- > Aluminium

Length (mm)	Silver	Black
1800	944.02.700	944.02.730
2700	944.02.701	944.02.731
3600	944.02.702	944.02.732

Packing 1 piece

MID RAIL

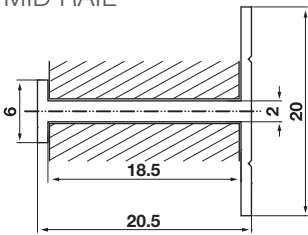

- > Decorative profile for top and bottom of door, suits board thickness up to 18mm
- > Aluminium

Length (mm)	Silver	Black
2700	944.02.302	126.14.935

Packing 1 piece

END PANEL EXTRUSION

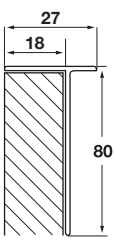

- > End panel extrusion, suits board thickness up to 18mm
- > Aluminium

Length (mm)	Silver	Black
2750	944.02.627	126.14.938

Packing 1 piece

END PANEL EXTRUSION WITH RETURN

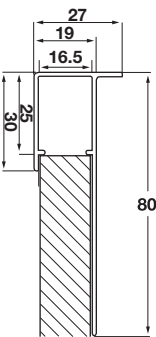

- > End panel extrusion with return, suits board thickness up to 16mm
- > Aluminium

Length (mm)	Silver	Black
2750	944.02.427	126.14.937

Packing 1 piece

FITTING SET

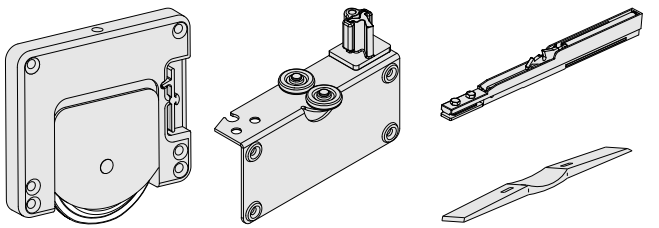

- > Fitting set, for sliding doors up to 50kg

	Cat. No.
For 2 doors	403.90.000
For 3 doors	403.90.001
Additional soft close mechanism	403.90.011

Packing 1 set

- Fitting sets supplied with:**
 - > Bottom rollers
 - > Top guides
 - > Soft close mechanisms

- Note:** Consider substrate weights and measures when calculating sliding panel weights. Centre door position guide supplied only in 3 door set.



732.04.604 SOFT CLOSE SLIDING SYSTEM - 08.2020

Häfele Australia Pty. Ltd. | 8 Monterey Road | Dandenong | Victoria 3175

Phone: 1300 659 728 | **Fax:** (03) 9212 2001 | **Email:** info@hafele.com.au | www.hafele.com.au

Häfele New Zealand Ltd. | 16 Accent Drive | East Tamaki | Auckland 2013

Phone: 0800 442 335 | **Email:** info@hafele.co.nz | www.hafele.co.nz

HÄFELE LOCATIONS:

Australia | MELBOURNE | SYDNEY | NEWCASTLE | BRISBANE | ADELAIDE | LAUNCESTON | HOBART | PERTH

New Zealand | AUCKLAND | WELLINGTON | CHRISTCHURCH

