

# MATRIX PRO MEDICAL.

THE SPACE WINNER FOR PRACTICE  
AND LABORATORY.



## FRONT AND FINISHED.

Häfele Matrix Pro Medical is the new Häfele drawer for practice and laboratory. The practical prefabricated drawer made from powder-coated steel saves the board material as well as the processing of the drawer and thus valuable time and costs.

In other words: no base, no rear panel, no assembly required – simply fit the front panel and you're ready!



## GIVING NOTHING AWAY.

### LESS IS MORE.

The Matrix Pro Medical allows low front panel heights from 61 mm and does not waste any space between the drawers – so more drawers fit into the cabinet.

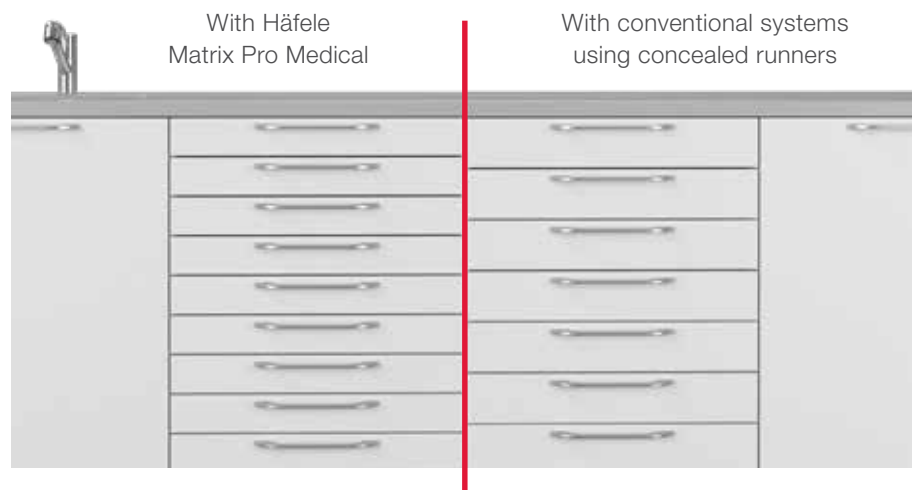

### SHEER EFFICIENCY.

The low base height of just 1 mm makes perfect use of the entire space. The 90° inner walls also ensure optimum space utilisation in the drawer and simplify the use of inserts.



Conventional drawer systems

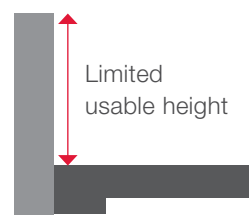

Matrix Pro Medical

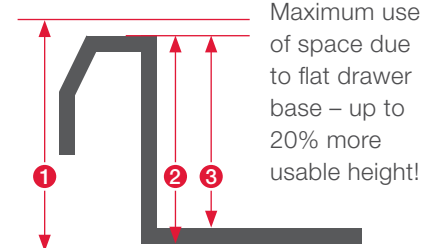

- ① Front panel height min. 61 mm
- ② Drawer height 59 mm
- ③ Usable height 58 mm

## MADE TO FIT.

The Matrix Pro Medical assortment offers the right insert for every need for different drawer heights and nominal lengths.

The numerous coordinated plastic instrument inserts and compartment inserts fit perfectly in the drawer and provide organisation and easy access.



Inserts for drawer heights of 59 mm or 120 mm

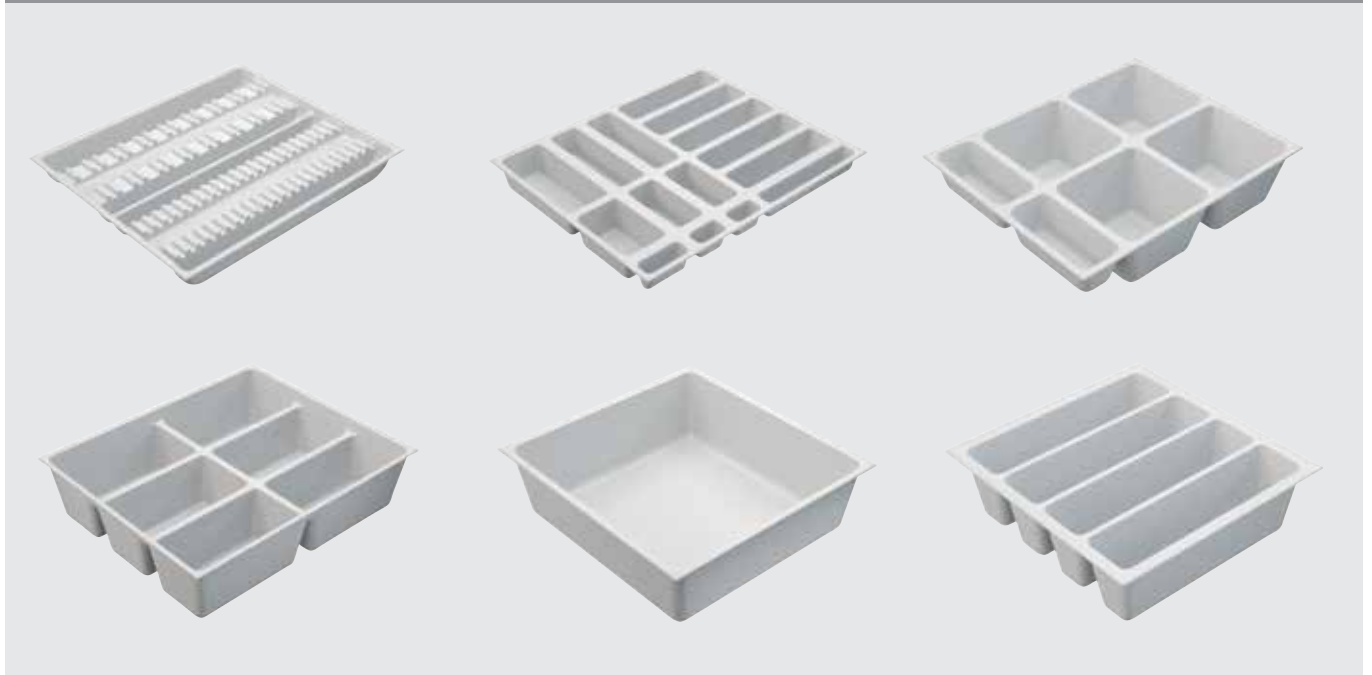

# HÄFELE MATRIX PRO MEDICAL.

## OPTIMUM USE OF SPACE WITH MAXIMUM CONVENIENCE.

The Matrix Pro Medical is available with either full or over-extension drawer slides. The convenient full extension gives you free access to the entire contents. With an over-extension, the practical plastic inserts can also be easily removed completely from above without tilting.



## NEAT AND TIDY.

The smooth metal surface can be cleaned simply and thoroughly, even liquids are not a problem. The gap-free interior of the drawer also reduces dirt accumulation.



The convenient 3-dimensional front panel adjustment from the inside provides a uniform gap alignment in an instant.



## HÄFELE MATRIX PRO MEDICAL DRAWER

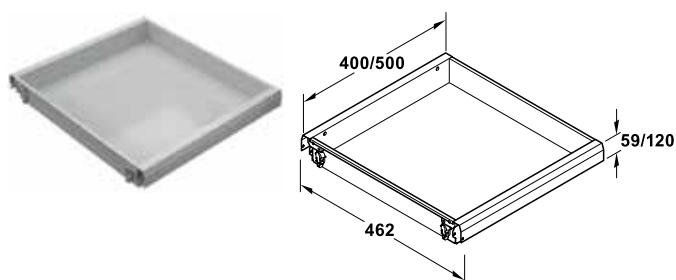

- > Area of application: For installation in laboratory and treatment room cabinets
- > Features: Optimum use of space in laboratory and treatment room cabinets  
Complete drawer: Cutting base panels or rear panels not required  
Panel height from 61 mm, panels 3-dimensionally adjustable  
Full extension with self closing and soft closing mechanisms  
Wide range of instrument compartments and compartment trays
- > Material: Steel
- > Finish: Powder coated
- > Colour: Traffic white, RAL 9016
- > Internal installation width (mm): 462 mm

Nom. length (mm)	Drawer side height (mm)	Inner drawer dim. WxDxH (mm)	Cat. No.
400	59	401 x 382 x 58	429.45.761
	120	401 x 382 x 119	429.45.763
500	59	401 x 482 x 58	429.45.771
	120	401 x 482 x 119	429.45.773

Packing: 1 piece



**Note:**  
Internal installation depth = nominal length + 3 mm  
Please order panel fixing screw (Cat. No. 013.10.190) separately.

## MATRIX PRO MEDICAL DRAWER RUNNERS



- > Load bearing capacity: Full extension: 35 kg  
Over extension: 30 kg
- > Material: Steel
- > Finish: Galvanised
- > Version: Full extension or over extension with soft closing mechanisms
- > Installation: Screw fixing onto side panel

Version	Drawer length (mm)	Cat. No.
Full extension	400	551.50.443
	500	551.50.445
Over extension	400	551.50.643
	500	551.50.645

Packing: 1 pair



**Note:**  
Internal installation depth = nominal length + 3 mm

## CABINET STRUT

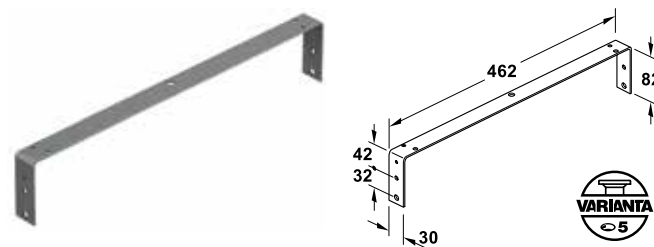

- > Area of application: For stabilising cabinets without cabinet top panel
- > Material: Steel
- > Finish: Galvanised
- > Material thickness (mm): 2.5
- > Internal installation width (mm): 462
- > Installation: For screw fixing to cabinet side panel and worktop

Dimensions WxDxH (mm)	Cat. No.
462 x 30 x 82	429.45.950

Packing: 1 piece



MATRIX PRO MEDICAL INSERTS

> Area of application:	For inserting in the Häfele Matrix Pro Medical drawer
> Material:	Plastic
> Colour:	White

For 59 mm drawer height

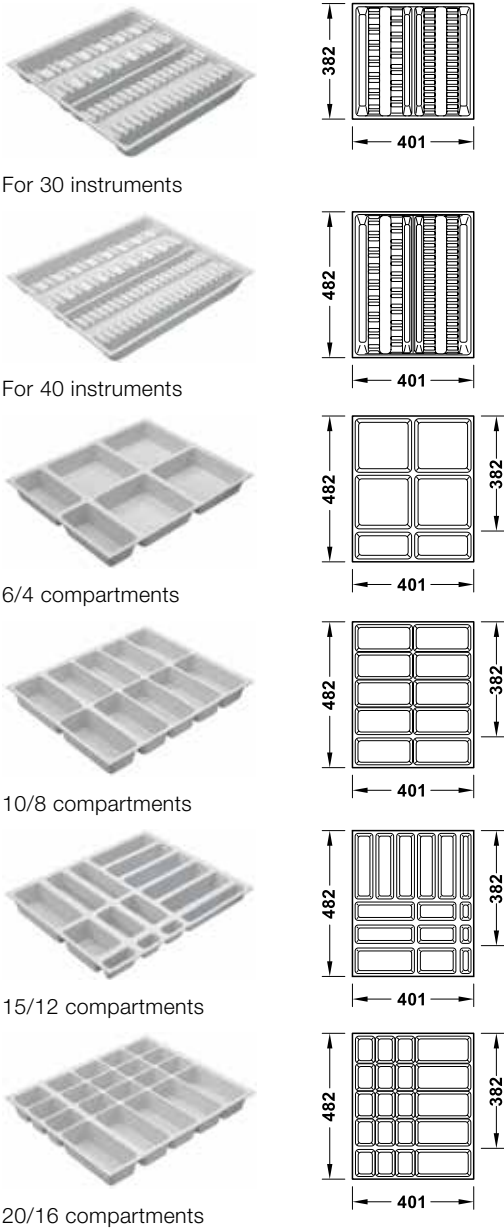

> Dimensions WxH (mm): 401 x 56
---------------------------------

Suitable for	Quantity	Depth (mm)	Cat. No.
Drawer depth 400 mm	30 instruments	382	429.35.740
Drawer depth 500 mm	40 instruments	482	429.35.754
Drawer depth 400 and 500 mm	6/4 compartments	482	429.35.751
	10/8 compartments	482	429.35.753
	15/12 compartments	482	429.35.750
	20/16 compartments	482	429.35.752

Packing: 1 piece

For 120 mm drawer height

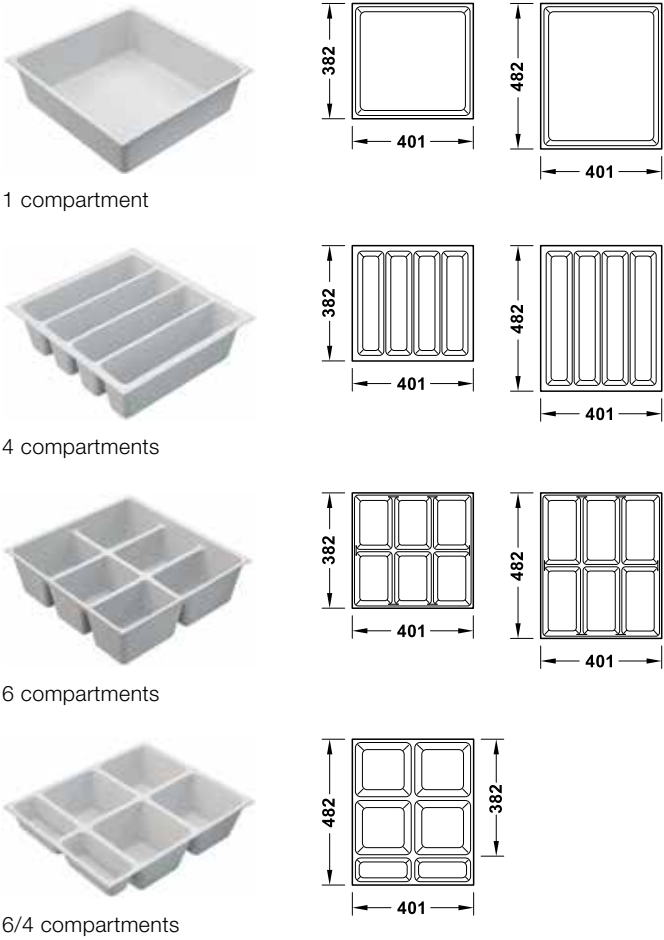

> Dimensions WxH (mm): 401 x 117
----------------------------------

Suitable for	Quantity	Depth (mm)	Cat. No.
Drawer depth 400 mm	1 compartment	382	429.35.743
	4 compartments	382	429.35.741
	6 compartments	382	429.35.742
Drawer depth 500 mm	1 compartment	482	429.35.758
	4 compartments	482	429.35.756
	6 compartments	482	429.35.757
Drawer depth 400 and 500 mm	6/4 compartments	482	429.35.755

Packing: 1 piece

## HAILO TANDEM ANTIBAK, 30 (2X15) LITRE CAPACITY

Antibacterial built-in waste separation for carcase with min. width 300mm, base mounted behind hinged door

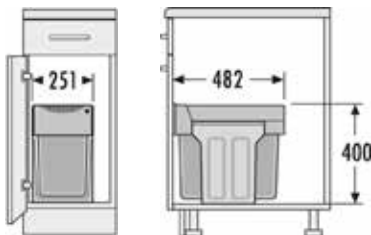
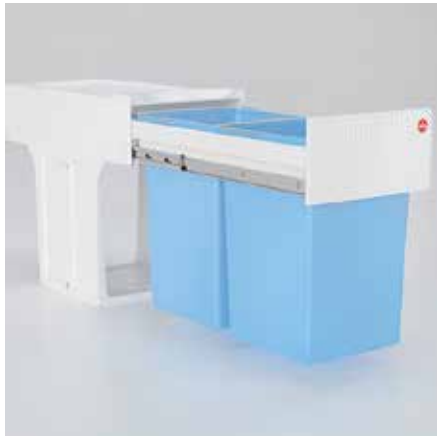

- > Area of application: For hinged door cabinets. Suitable for use in the home, medical facilities, nurseries, offices, etc.
- > Features: Designed to be withdrawn from the cabinet whilst the lid lifts and remains in the cabinet  
The frame incorporates its own runners and is secured to the carcase base
- > Material: Bin holder mounting components and runners: steel  
Lid and pails: Plastic with silver ion antibacterial additive
- > Colour: White plastic-coated holder, blue plastic pails and white plastic lid
- > Total capacity (ltr): 30 (2x15)

**Cat. No.**

502.71.782

Packing: 1 piece

## Safety not just for the home



The AntiBak line from Hailo is suitable not only for the home, but also for medical facilities (eg: hospitals, doctor's clinics, dental surgeries) as well as for nurseries, schools, offices, etc.

## 99.9% less bacteria on plastic parts thanks to innovative surface structure

The special surface structure of the plastics used prevents the germination of pathogens of any kind. All plastic surfaces, such as the system lid, handle panel and inner bins have been given antibacterial protection through the addition of silver ions, reducing the reproduction of bacteria by up to 99.9%.

The active antibacterial agent is contained in the processed plastic, ensuring it remains active and offers lasting antimicrobial protection for many years.

- > Lasting permanent antibacterial protection
- > Full antibacterial effect even after 15 years
- > Material tested against more than 50 types of bacteria
- > Tested in over 2,000 applications
- > Test certificates available
- > Unusually high speed of action
- > Does not contain any nanosilver



MAGRO BUILT IN WASTE BIN

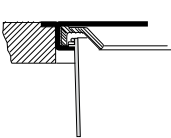
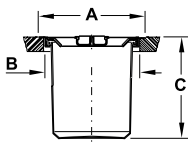

Flush mounted

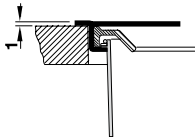

Surface mounted

> Installation:	For recess mounting or surface mounting
> Material:	Plastic, 5 litre bin: With stainless steel ring, 11 and 13 litre bin: With stainless steel ring and soft rubber ring Lid: Stainless steel

Capacity (ltr)	Dim. A (mm)	Dim. B (mm)	Dim. C (mm)	Cat. No.
5	237	205	230	502.94.002
11	310	280	300	502.94.000
13	310	280	350	502.94.001

Packing: 1 piece

WORKTOP GROMMET



Satin



Bright



Gold coloured

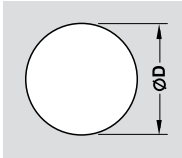
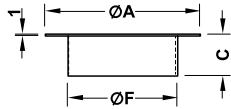

> Material:	Stainless steel
-------------	-----------------

Dim. A (mm)	Dim. F (mm)	Dim. C (mm)	Dim. D (mm)	Satin	Bright	Gold coloured
170	146	36	147	793.90.053	793.90.153	793.90.853

Packing: 1 piece



## PIVOT SLIDING DOOR RUNNERS

For pivot sliding flaps

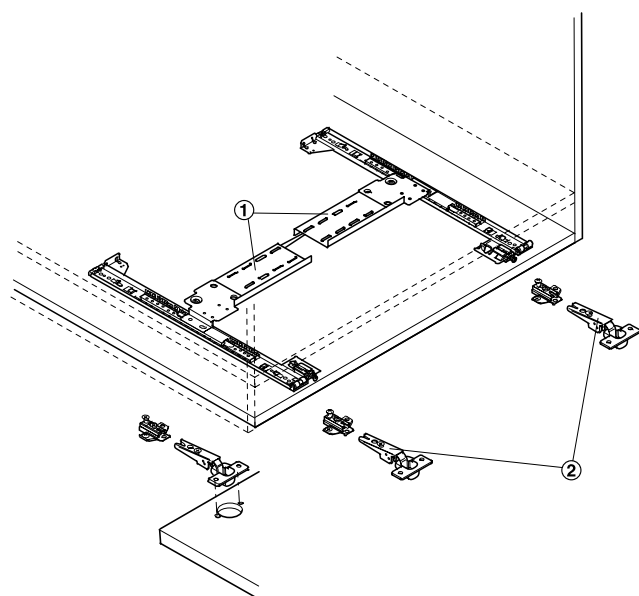

- ① Hinge carrier strip
- ② Flap fixing set

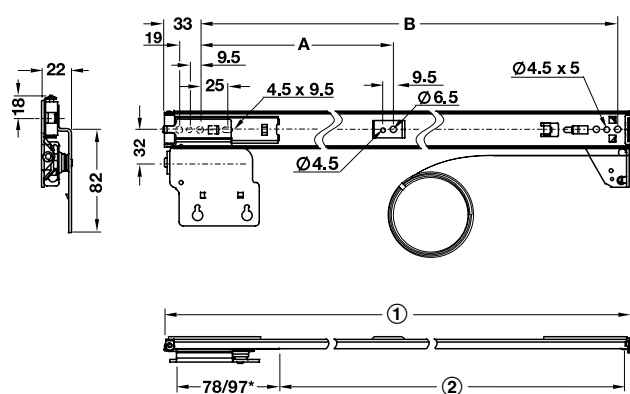

\* for installation lengths 303/354/405 mm

- ① Installation length
- ② Extension length

Installation length = min. cabinet depth that is required for installing the fitting

Extension length = max. flap height that can be moved into the cabinet

- > Area of application: For swivelling up and sliding in flaps
- > Features: Excellent running properties provided by synchronised runners  
With pull cable system for synchronous movement of left and right runner  
Can also be installed vertically (for hinged doors)
- > Door width (mm): 915 - 2000
- > Door height (mm): 255 - 600
- > Door thickness (mm): 19 - 32

Installed length (mm)	Door retraction depth (mm)	Dim. A (mm)	Dim. B (mm)	Cat. No.
354	261	-	307	408.24.535
405	312	-	358	408.24.541
456	343	178	409	408.24.546
506	394	203	460	408.24.551
557	445	229	511	408.24.556

Packing: 1 pair



### Supplied with:

- > 1 Pair of runners with pull cable
- > Fixing material



### Note:

The flap must not be subjected to loads in the open, not pushed-in position. It must be continuously guided and pushed-in by hand during the entire opening procedure.

## HINGE CARRIER STRIP SET

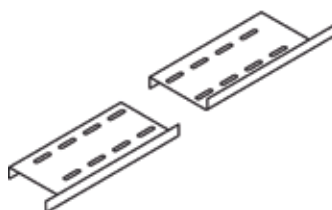

- > Material: Steel
- > Finish: Black

Flap width (mm)	For 1 flap	For 2 flaps
915-1422	1 set	2 sets
1423-2000	2 sets	3 sets

Cat. No.
408.24.090

Packing: 1 or 3 sets



### Supplied with:

- > 2 Hinge carrier strips
- > 3 Connecting clips
- > Fixing material

**FLAP FIXING SET**  
For inset mounting

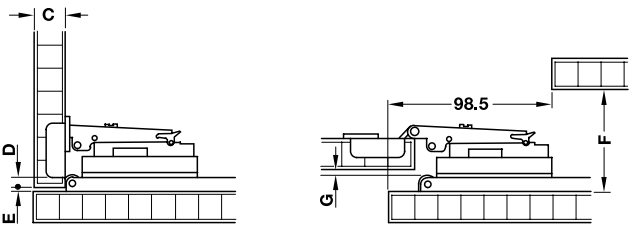

Dim. C (mm)	Dim. D (mm)	Dim. E (mm)	Dim. F (mm)	Dim. G (mm)
19	8	2.3	51	1.4
19	9	1.8	51	0.3
19	15	2.3	60	14.4
21	15	2.3	60	12.8

**Order reference**

Number of required flap fixing sets per flap:

Flap width (mm)	Required number of hinges	Required number of sets
915-1193	3	2
1194-1498	4	2
1499-1803	5	3
1804-2000	6	3

Door thickness (mm)	Version	Cat. No.
19-20	Cup drilling Ø 35 mm	408.24.092

Packing: 1 set



- Supplied with:**
- > 2 Concealed hinges
  - > 2 Mounting plates
  - > 2 Spacers
  - > Fixing material

**For overlay mounting**

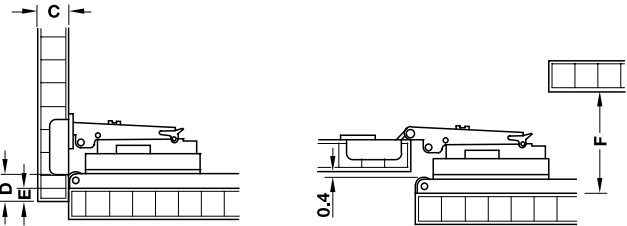

Dim. C (mm)	Dim. D (mm)	Dim. E (mm)	Dim. F (mm)
19	15	11.7	60

**Order reference**

Number of required flap fixing sets per flap:

Flap width (mm)	Required number of hinges	Required number of sets
915-1193	3	2
1194-1498	4	2
1499-1803	5	3
1804-2000	6	3

Door thickness (mm)	Version	Cat. No.
19	Cup drilling Ø 40 mm	408.24.093

Packing: 1 set



- Supplied with:**
- > 2 Concealed hinges
  - > 2 Mounting plates
  - > 2 Spacers
  - > Fixing material

# ANTIBACTERIAL COATING.

FOR THE HIGHEST CLEANLINESS AND HYGIENE DEMANDS.

## HÄFELE DESIGN MODEL H2155



- > Cat. No. left 101.69.511
- > Cat. No. right 101.69.510
- > Dim.: 100 x 24 mm
- > Hole Spacing: 16 mm

The antibacterial surface coating offers an innovative additional benefit to the design and quality of Häfele furniture handles. The natural antibacterial effect can effectively inhibit the transmission of infections. 80% of all infectious diseases are transmitted by contact. The special coating provides highly effective protection to break the chain of infection.

- > Infection prevention: Inhibition of contact contamination and spread of infectious diseases
- > Improved hygiene: Ideal complement to the usual infection prevention procedures (such as frequent hand washing, disinfection and cleaning of surfaces).
- > Antibacterial effect: Antimicrobial properties of silver ions are used to control bacterial growth.
- > Customised: Other handles from the Häfele range are available with an antibacterial surface on request.



### REDUCTION IN OCCURENCE OF BACTERIA.

Reduction of the micro-organisms and bacterial growth. The surfaces are therefore extremely clean and hygienic.



### TRIED AND TESTED.

Tested in accordance with international standard ISO 22196:2011.



### HIGH QUALITY AND DURABILITY.

Increased chemical and physical durability due to the effectiveness of active metals which protect the surface.



### TIMELESS AND MODERN DESIGN

Chic Häfele Design for a stylish finishing touch to furniture in public places or risk zones in the health care sector.



#### Häfele Design Model H2125

- > Cat. No. 106.65.610
- > Dim.: 171 x 27 mm
- > Hole Spacing: 160 mm



#### Häfele Design Model H2125

- > Cat. No. 106.65.810
- > Dim.: 171 x 27 mm
- > Hole Spacing: 160 mm



#### Häfele Design Model H2120

- > Cat. No. 106.65.600
- > Dim.: 174 x 32 mm
- > Hole spacing: 160 mm



#### Häfele Design Model H2120

- > Cat. No. 106.65.900
- > Dim.: 174 x 32 mm
- > Hole spacing: 160 mm



#### Häfele Design Model H1525

- > Cat. No. 106.65.690
- > Dim.: 172 x 33 mm
- > Hole spacing: 160 mm



MATRIX PRO MEDICAL - 02.2022

**Häfele Australia Pty. Ltd.** | 8 Monterey Road | Dandenong | Victoria 3175  
**Phone:** 1300 659 728 | **Fax:** (03) 9212 2001 | **Email:** [info@hafele.com.au](mailto:info@hafele.com.au) | [www.hafele.com.au](http://www.hafele.com.au)

**Häfele New Zealand Ltd.** | 16 Accent Drive | East Tamaki | Auckland 2013  
**Phone:** 0800 442 335 | **Email:** [info@hafele.co.nz](mailto:info@hafele.co.nz) | [www.hafele.co.nz](http://www.hafele.co.nz)

**HÄFELE LOCATIONS:**

**Australia** | MELBOURNE | SYDNEY | NEWCASTLE | BRISBANE | ADELAIDE | LAUNCESTON | HOBART | PERTH  
**New Zealand** | AUCKLAND | WELLINGTON | CHRISTCHURCH

